

BRACKET FOR BIKE RACK (EU)

The HeroCamper's Bracket For Bike Rack opens up new possibilities for your outdoor adventures by providing an easy and secure way to attach a bike rack or tow box. Whether you're planning a cycling trip or need extra space on your camping trip, this bracket offers a flexible solution that makes it simple to bring everything you need. Designed for convenience and durability, it allows you to maximize your HeroCamper's functionality, giving you more room for the things that make your trips memorable. With a maximum load capacity of 75 kg, it's the perfect accessory to ensure you're fully equipped for any adventure.

COMPONENTS

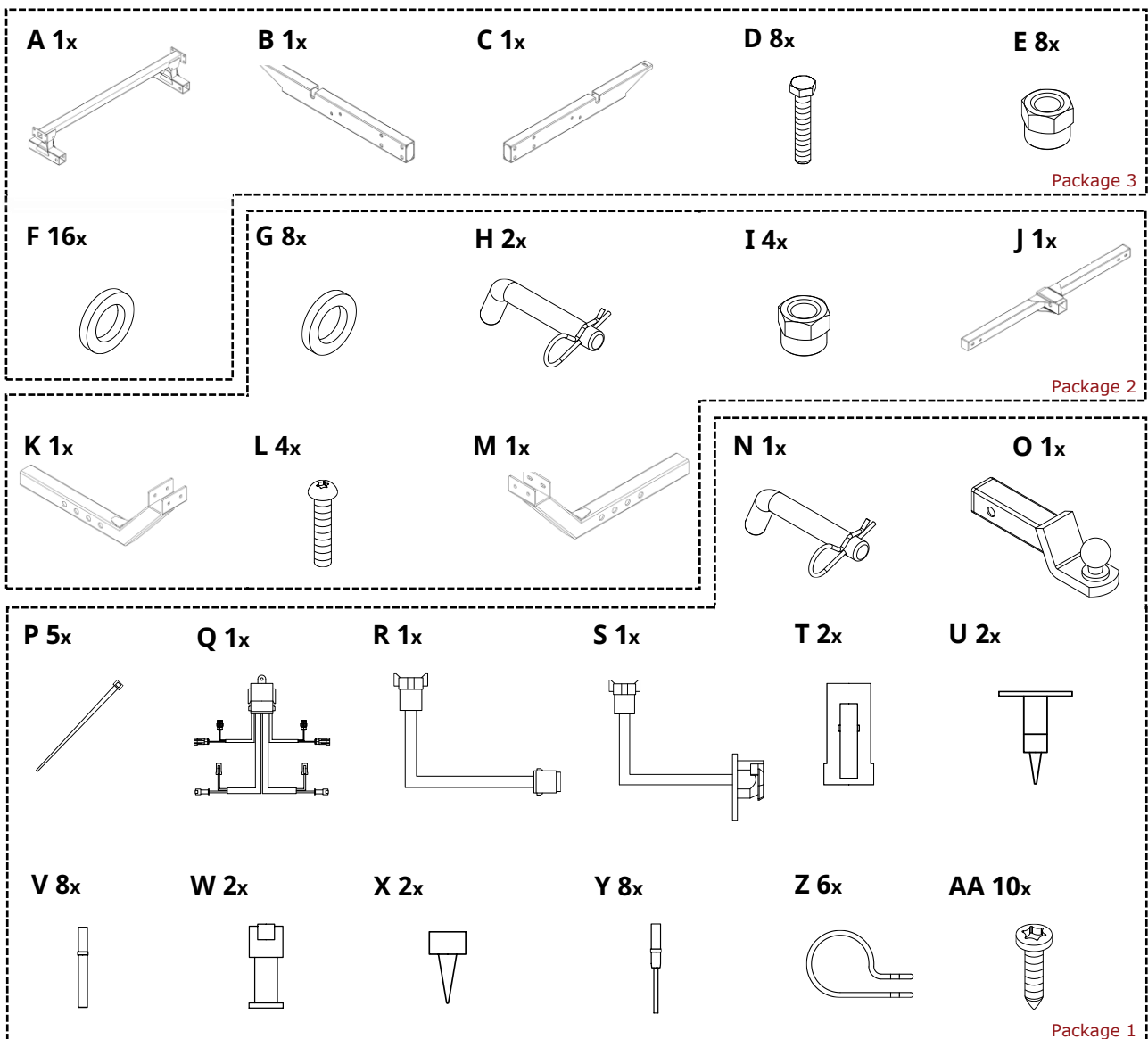

A: Recovery Beam Center **B:** Recovery Beam Left **C:** Recovery Beam Right **D:** M12x70mm Hexagon bolt **E:** M12 Nut **F:** M12 Washer **G:** M8 Washer **H:** Safety Split **I:** M8 nut **J:** Adapter Bracket Main Unit **K:** Adaptor Bracket Left Unit **L:** M8x75mm Torx bolt **M:** Adaptor Bracket Right Unit **N:** Safety Split **O:** Ball Bracket 50mm **P:** Zip tie **Q:** Wire Harness 1 **R:** Wire harness 2 **S:** 13-pin wire harness **T:** Rear Light Multiplug 1 **U:** Multiplug inner part 1 **V:** Terminal 1 **W:** Multiplug 2 **X:** Multiplug Inner part 2 **Y:** Terminal 2 **Z:** Wire Clamp **AA:** Torx Pan head ST4.2x19

HeroCamper - www.herocamper.com

Lammefjordsvej 5 - 6715 Esbjerg N - Denmark

Phone +45 7022 5840 - sales@herocamper.com

VAT No DK - 40193189

Version 27-09-2024

SAFETY INSTRUCTIONS

- HeroCamper assumes no liability for injury to persons, damage to movable or immovable property, loss of profit, or any other loss or damage caused by the improper mounting or use of the product, including but not limited to mounting or use in conflict with the assembly instructions given, in writing or verbally, by HeroCamper or HeroCamper Dealer.
- The product and its parts must not be modified in any way.
- Consult your HeroCamper dealer if you have any questions about the function, use and limits of the product. Read all the instructions and warranty information carefully before starting the mounting and using of the product.
- Check the assembly instructions to make sure all the necessary parts of the product are present.
- Read and follow the assembly instructions and the recommendations carefully. Then fit the unit in the correct sequence by following step 1, 2, 3, and so on.
- Do not attempt to fit the product in any other way than the way shown in the installation guide
- The maximum load on the product is 75kg and must not be exceeded. In addition, the maximum load recommended for the vehicle itself always takes priority over the load specified in the assembly instructions. It is always the lower recommended maximum load that applies and that must not be exceeded. This applies to vehicles/HeroCamper in motion as well as parked.
- Manuals and limitations from other product applied such as, bike carrier cargo box etc. must be according to the specific manual and recommendations
- If necessary, the load must be fitted with the appropriate lights and warning signs in according with local laws.
- Check the load fastenings regularly.
- The vehicle driver is solely responsible for ensuring that the product is in perfect condition and that its load is securely fastened. This also include if fitted by a 3rd person.
- Every time the product is used, check that the that it is securely fitted after driving a short distance ~50km and then at regular intervals. If you notice any unusual noise, movement of the load and/or different behavior of the vehicle or other unusual conditions, stop and check everything is secured correctly and in accordance with the installation instructions.
- The car and campers' total length, weight and/or height may increase. Please note when reversing or entering ferries, garages etc.
- Do not let the load exceed national regulations regarding length, weight and height. We recommend not to exceed the width of the current camper
- Replace any damaged or worn parts of the product immediately. During use all bolts/nuts must be tightened in accordance with the installation instructions
- Be aware that the vehicle's driving characteristics and braking behavior might change, and that the vehicle might become vulnerable to side winds depending on the add-on for this product.
- And additional number plate might be required. This should be attached to accordance with local laws.
- The vehicle's speed must always be adjusted to the load being carried and the current driving conditions, such as the road type, road quality, wind conditions, traffic intensity and applicable speed limits.
- Drive slowly over speed bumps, maximum speed 10km/h.
- Be aware that wind noise may be generated during transport and may vary depending on the vehicle and load.
- For reasons of fuel economy and environmental impact as well as the safety of other road users, the detachable by hand part of the product must be removed from the camper when not in use.
- When the product is not mounted on the HeroCamper it must be stored in a dry storage area.
- If you lose part(s) of the product, only use genuine HeroCamper spare parts as replacements. Spare parts can be purchased from your dealer
- To ensure that you receive the spare parts correct and quickly, please inform the campers VIN number and order number if you purchased the product later than the camper

TOOLS FOR INSTALLATION



M8



2x M13



2x M19



TX 20



TX 25



PH 2



INSTALLATION GUIDE

1. Unscrew the 2x TX 25 screws for the support brackets and put them a side. There should be enough space to insert Recover Center Bracket Unit. Please see step 4. If this is not the case unscrew the support brackets completely with M8 wrench and a TX 20 screwdriver. Keep the bolts and nuts for later.

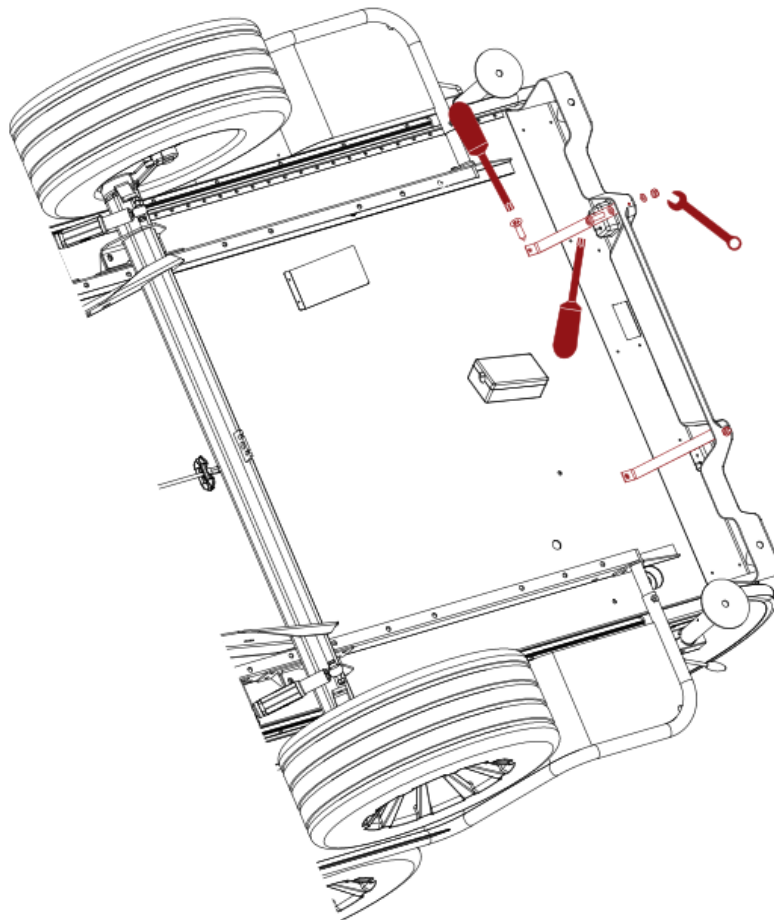

HeroCamper - www.herocamper.com

Lammefjordsvej 5 - 6715 Esbjerg N - Denmark

Phone +45 7022 5840 - sales@herocamper.com

VAT No DK - 40193189

Version 27-09-2024

2. Untighten the 2x bolts for the fender bracket with 2x M13 wrenches. The third bolt you will need to have access and from inside the camper to provide counter hold. Repeat on opposite side and keep the bolts, nuts and washers for next step.

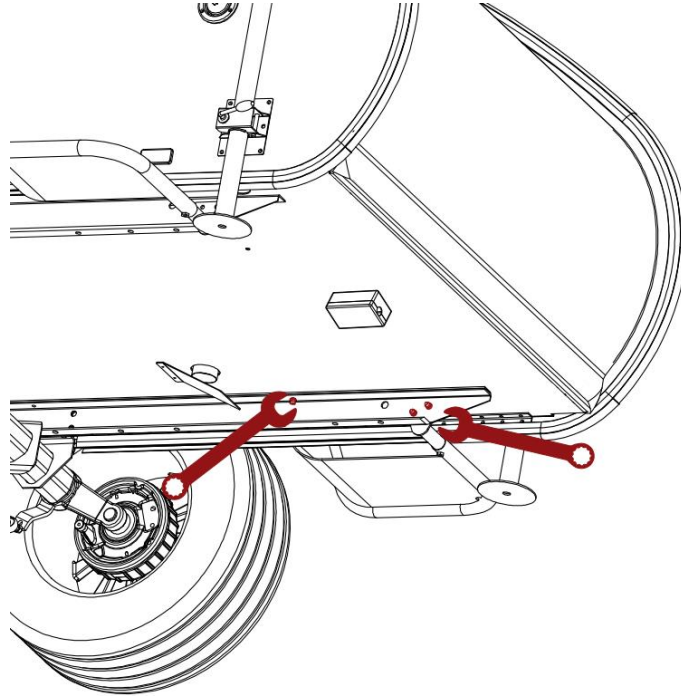

3. Insert Recovery Beam Left and Right into the chassis beams. Use the Bolts, nuts and washers from previous step and tighten it with two M13 wrenches to 20Nm. (Parts Used: **B** and **C**)

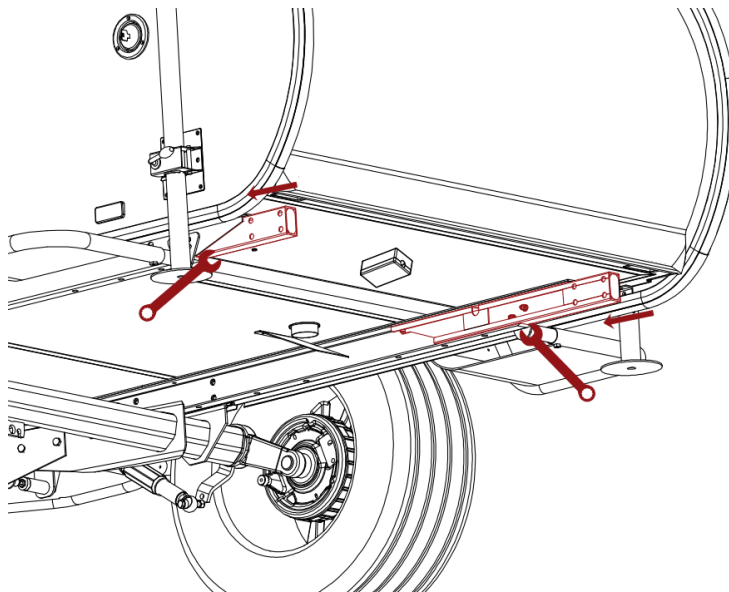

4. Please check if the junction box has a multiplug connection. If this is the case, please jump to step **15**.

Unmount the 4x PH screws to remove the cover of the junction box. Keep the screws and cover for later.

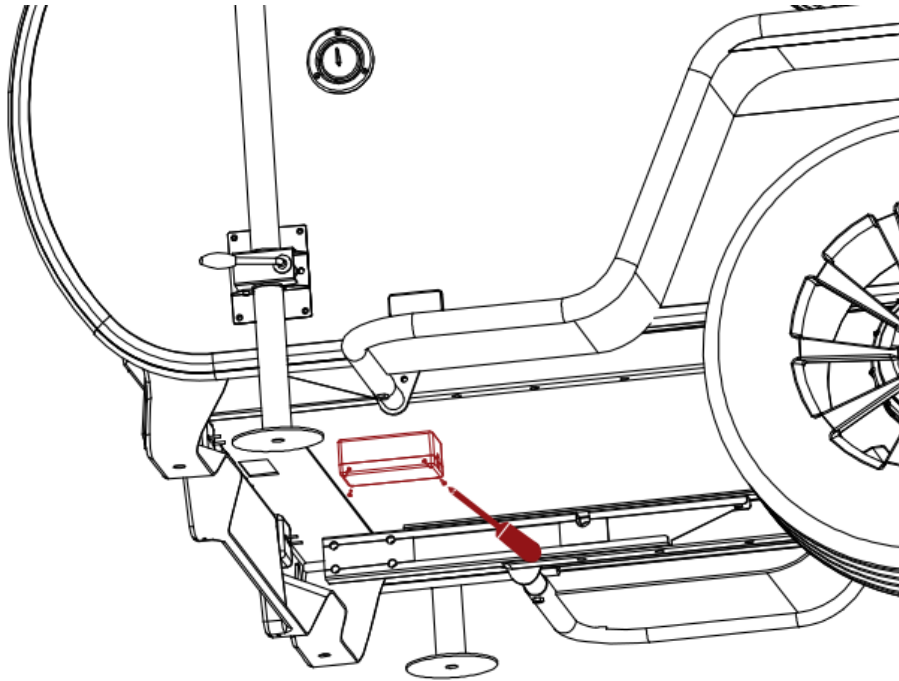

5. Please try and see if the **A Recovery Beam Center** can fit. If it is the case remove it again and go to step **7**. If the junction box interferes, please continue to next step.

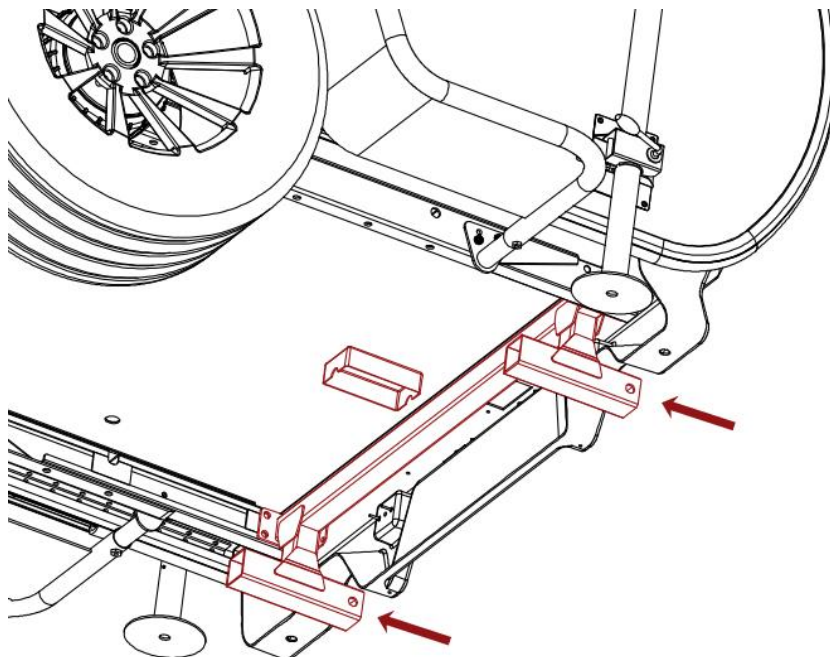

6. Unmount the 4x screws for the junction box and move it further towards the front to ensure space for the Recovery Beam Center. We advise to use silicone for the holes. Especially the ones that is not covered by the junction box.

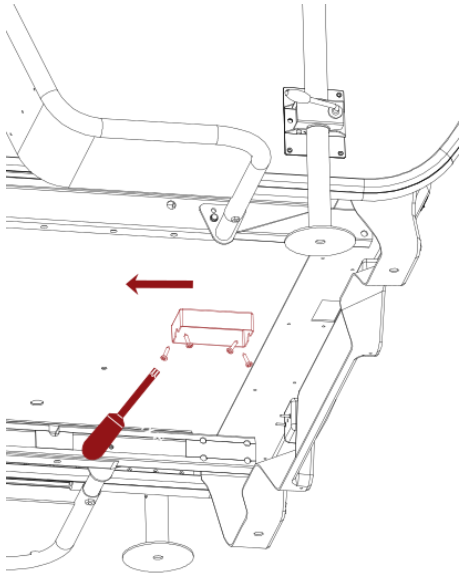

7. Disconnect the multiplugs with Pink/white- and Blue/white wires inside the junction box. Use the Wire Harness 1 and connect the wires labeled Fog Lamp to the Blue/White. Then connect multiplugs labeled Reversing lamp to the Pink/white. (Part Used: Q)

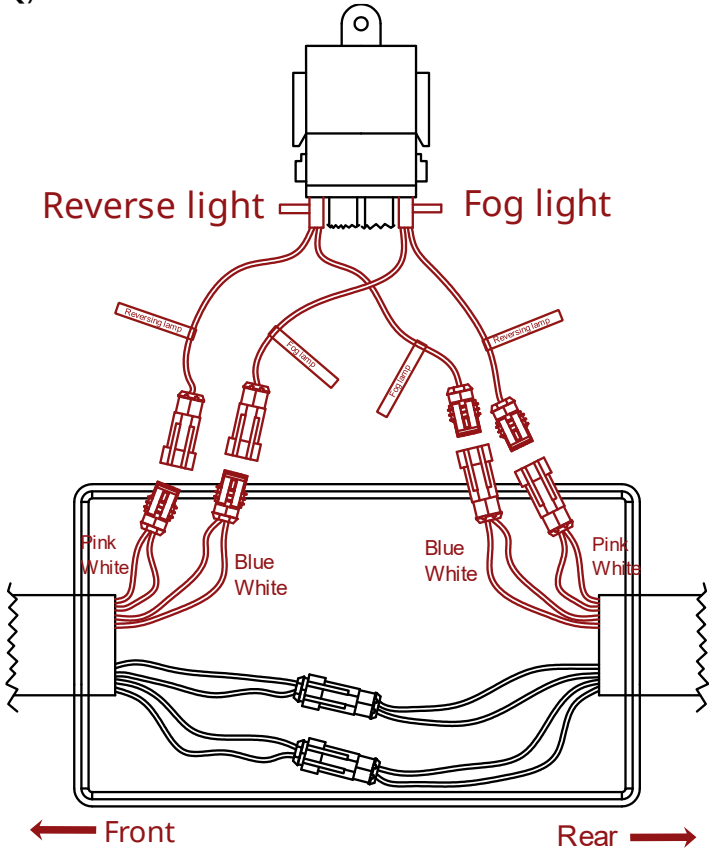

8. Ensure that the last 2 wires are placed outside the junction box before fastened the cover like illustrated below

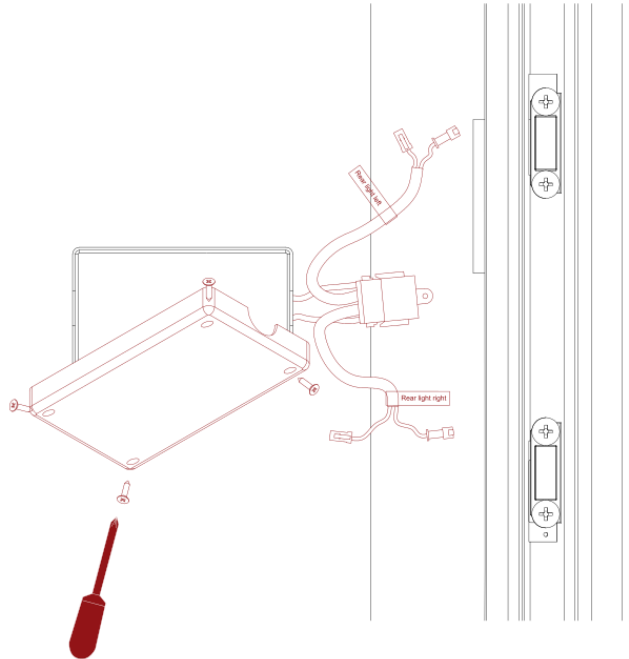

9. Remove the U-rubber profile, underneath the camper, by hand if this is covering the wire. Cut the zip tie if necessary and then cut the wire Snip the Zip tie with wire cutter on the left rear light wire harness under the trailer. Repeat on the opposite site.

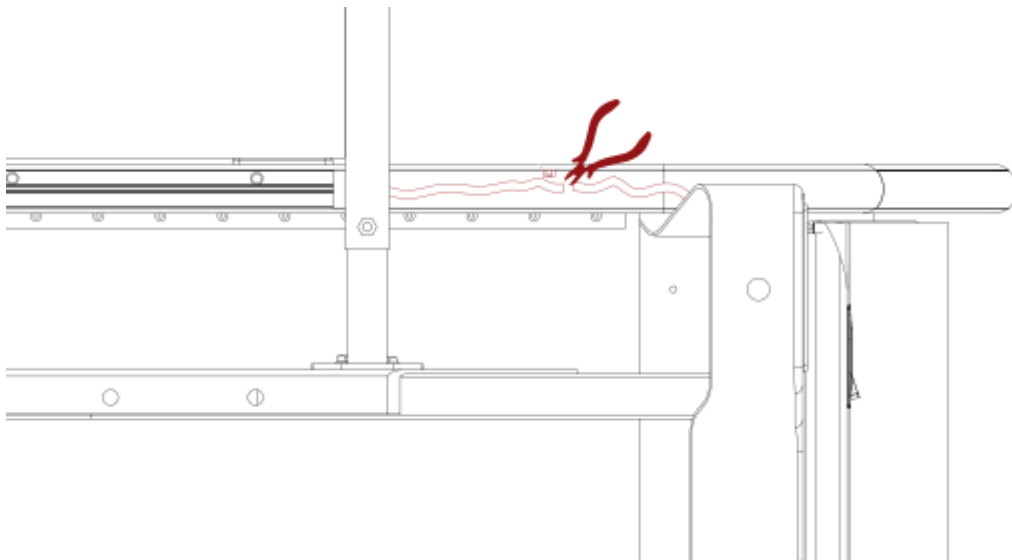

- Strip the wires on both sides of the wire. Make sure they are correct length for the terminals. Repeat on the opposite side.

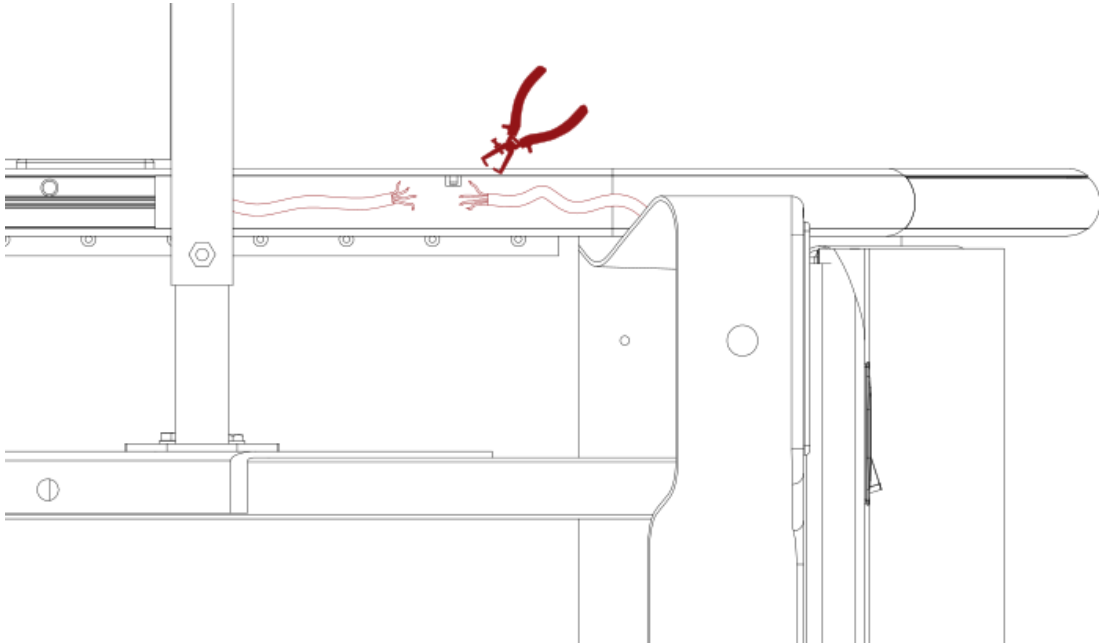

- Crimp the (V): Terminal 1 on the wire running towards the bumper. Then Crimp the (Y): Terminal 2 on the wire running towards the front. Repeat on the opposite side.
(Parts used: V and Y)

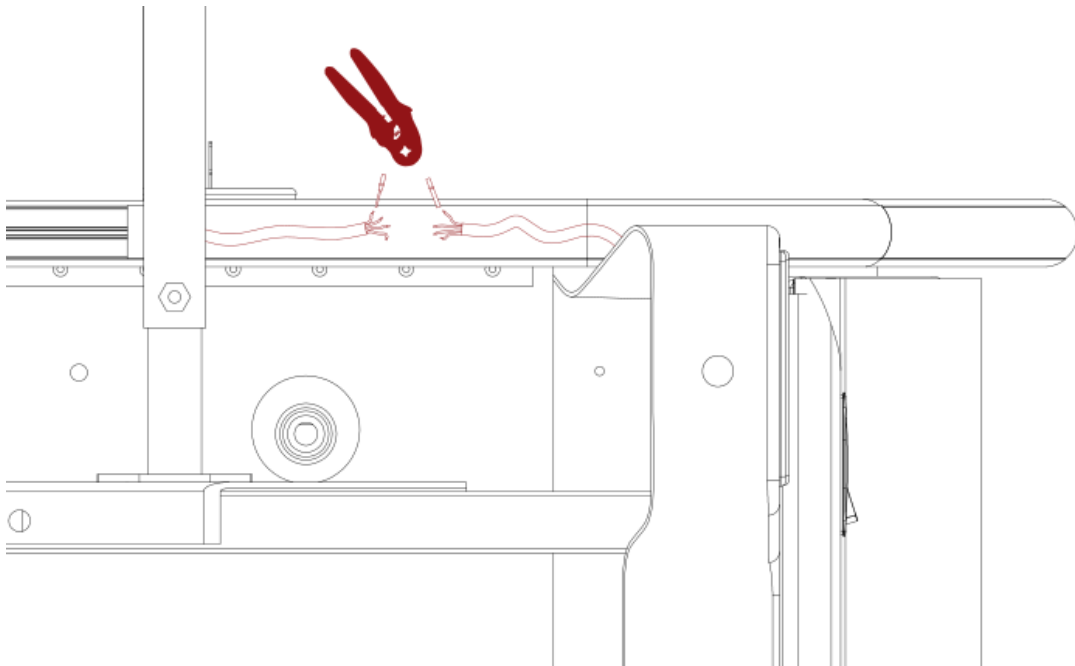

12. Please note below illustration is shown from below the camper. It is the left side of the HeroCamper. Use **(T)** Rear Light Multiplug 1 and insert the wires running towards the bumper. Red to Red1 – Yellow to Yellow 2 – Black to Black 3 – White to White 4. Ensure the wires makes a click sound to confirm they are fastened correctly. Insert the **U**: Multiplug inner part 1 into the multiplug.

Use the **W**: Multiplug 2 on the wire running towards the front of the camper. Connect Red to Red1 – Yellow to Yellow 2 – Black to Black 3 – White to White 4. Insert **X**: Multiplug Inner part 2 into the multiplug.

(Parts used: **T**, **U**, **W** and **X**)

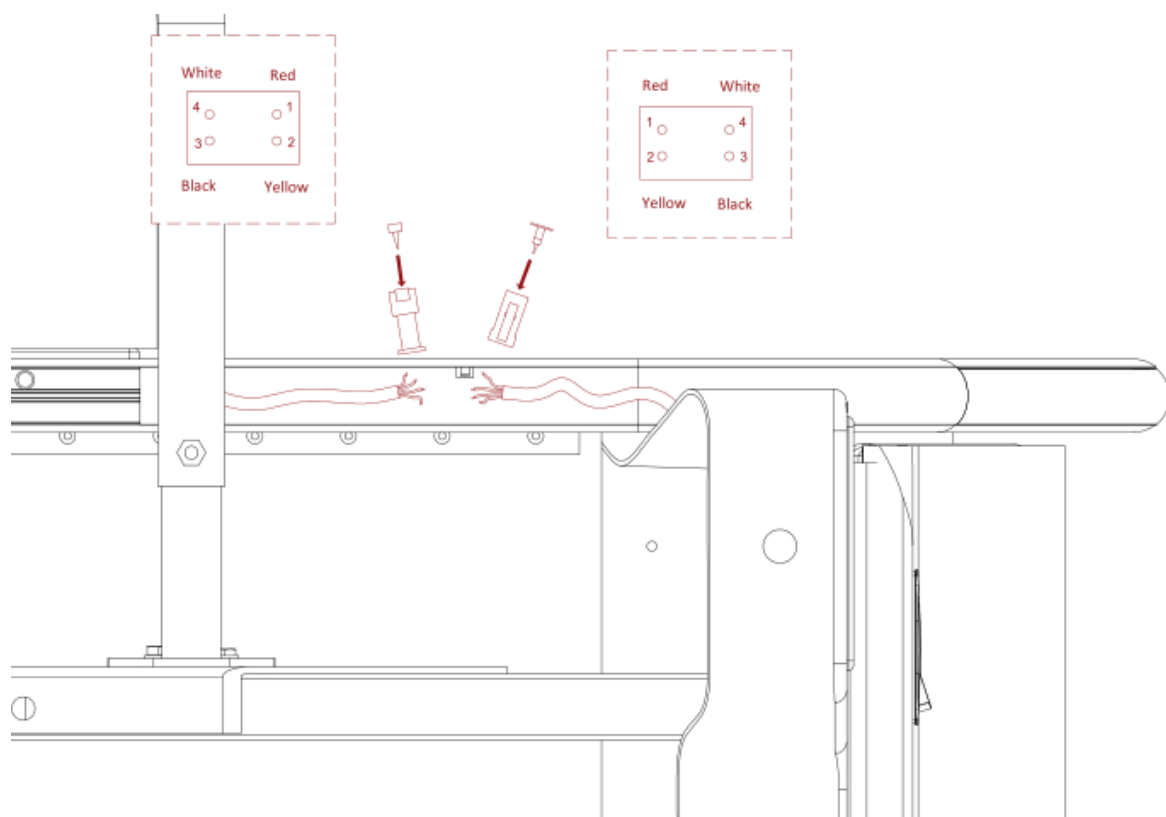

- 13.** Please note below illustration is shown from below the camper. It is the right side of the HeroCamper. Use **(T)** Rear Light Multiplug 1 and insert the wires running towards the bumper. Red to Red1 – Green to Green 2 – Brown to Brown 3 – White to White 4. Ensure the wires makes a click sound to confirm they are fastened correctly. Insert the **U**: Multiplug inner part 1 into the multiplug. Use the **W**: Multiplug 2 on the wire running towards the front of the camper. Connect Red to Red1 – Green to Green 2 – Brown to Brown 3 – White to White 4. Insert **X**: Multiplug Inner part 2 into the multiplug.
(Parts used: **T, U, W** and **X**)

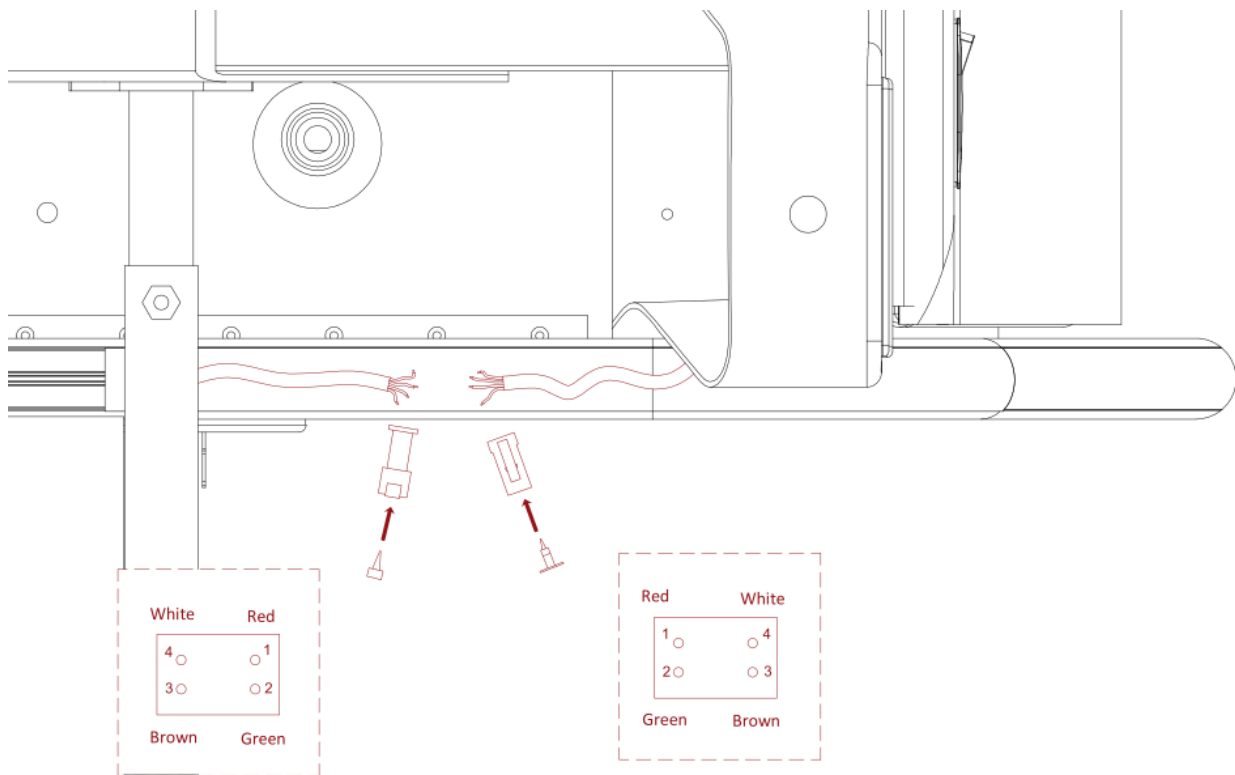

14. Please note below illustration is shown from below the camper. It is the left side of the HeroCamper. Connect the 2 multiplugs labelled "Rear light left". Remount the wires with a zip tie.

Attach the wire behind the bumper and fasten it with screws and wire clamps. Repeat this step on the right side of the camper. Please note the wire is labeled "Rear light right".

(Parts used: **P**, **Z**, and **AA**)

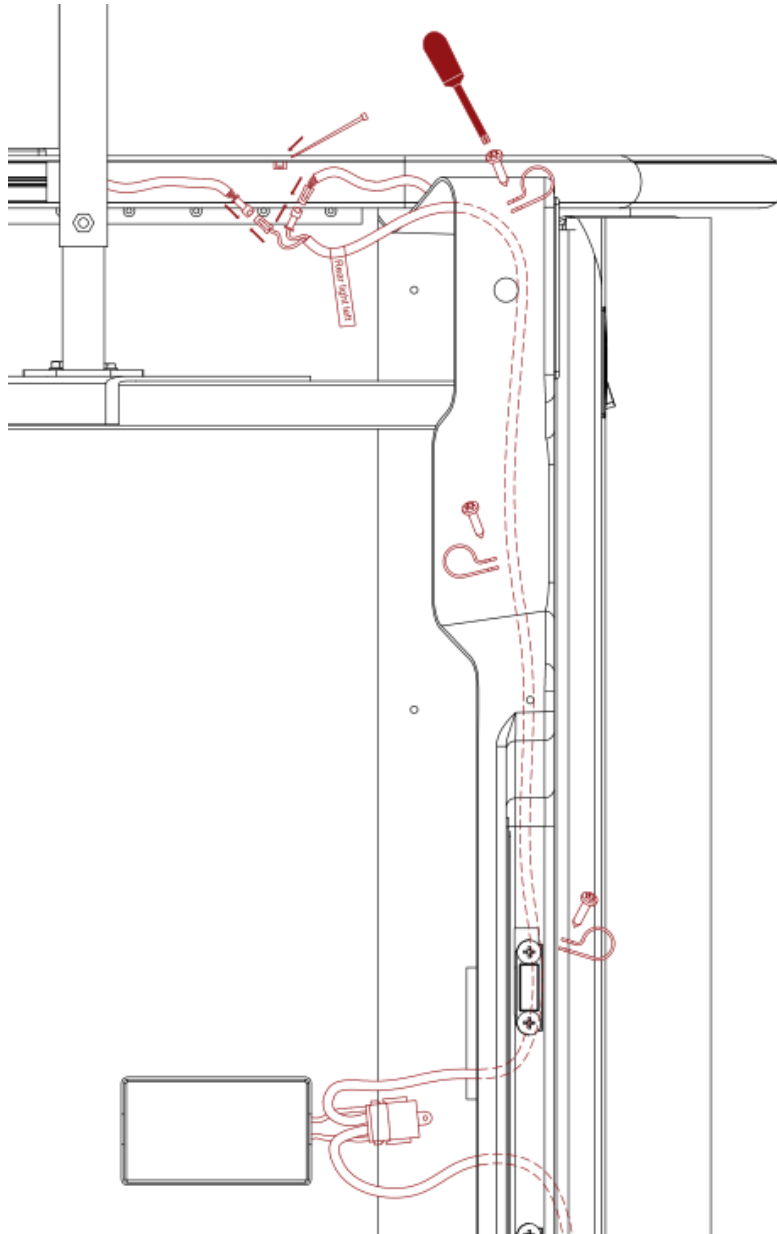

- 15.** Insert the Recovery Beam Center like step 5. Mount the beam with bolts, washers and nuts and tighten with 70Nm.
(Parts used: **A**, **D**, **E** and **F**)

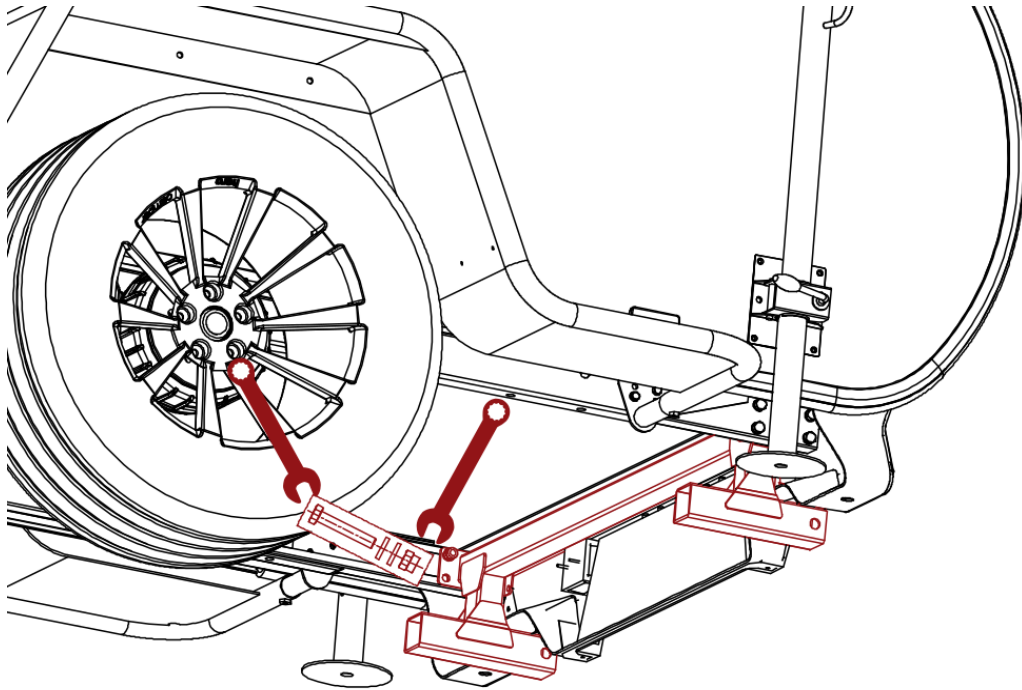

- 16.** Remove the dust cap from the Wire Harness 1. Please keep it and use it when the Adaptor bracket is not in use (see step 21). Connect the multiplug from Wire Harness 2 to Wire Harness 1. Attach the wire behind the bumper and fasten it with screws and wire clamps.
(Parts used: **R**, **Z** and **AA**)

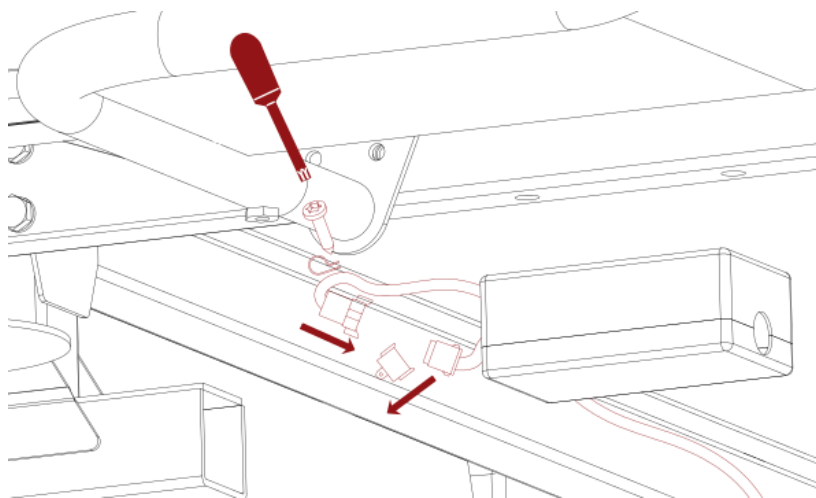

17. Attach the wire behind the bumper and fasten it with screws and wire clamps. Mount the bolt, washer, clamp and nut in the hole of the reinforcement plate like illustrated below.

(Parts used: **R**, **Z** and **AA**)

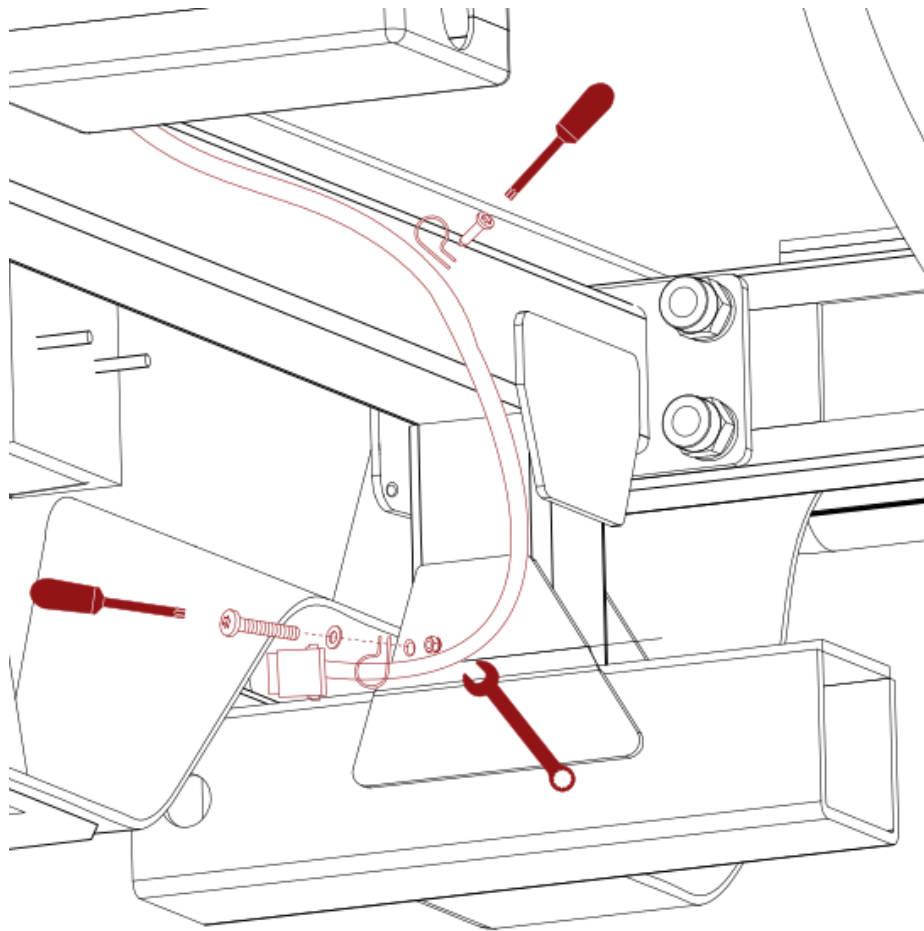

18. Combine the Adaptor Bracket Main Unit with the Left and Right part and fasten it like illustrated below.
(Parts used: **G, I, J, K, L** and **M**)

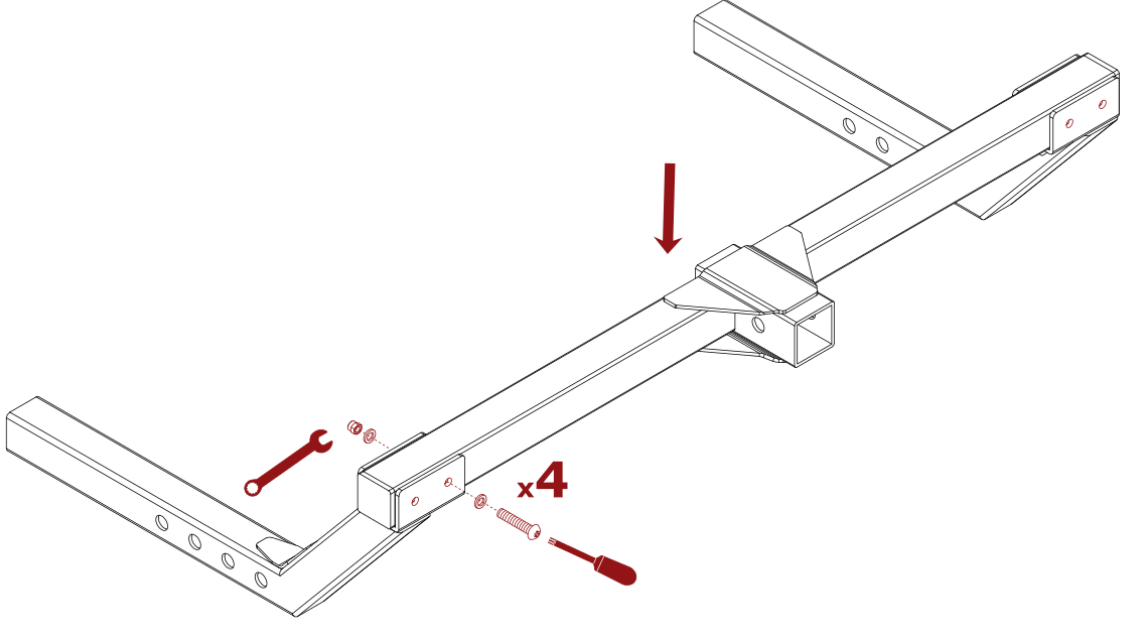

19. Insert the Adaptor Bracket into the Recovery Hitch. Secure it with the Safety Splits in both sides.
(Parts used: **H**)

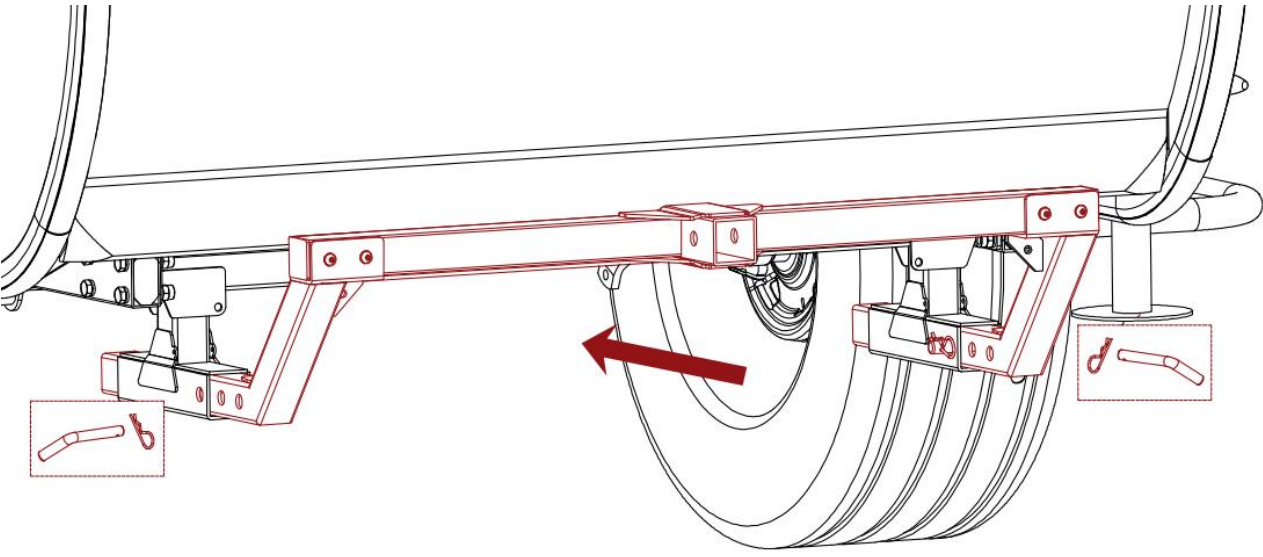

20. Insert the Ball Bracket 50mm and secure it with the Safety Split.
(Parts used: **O** and **N**)

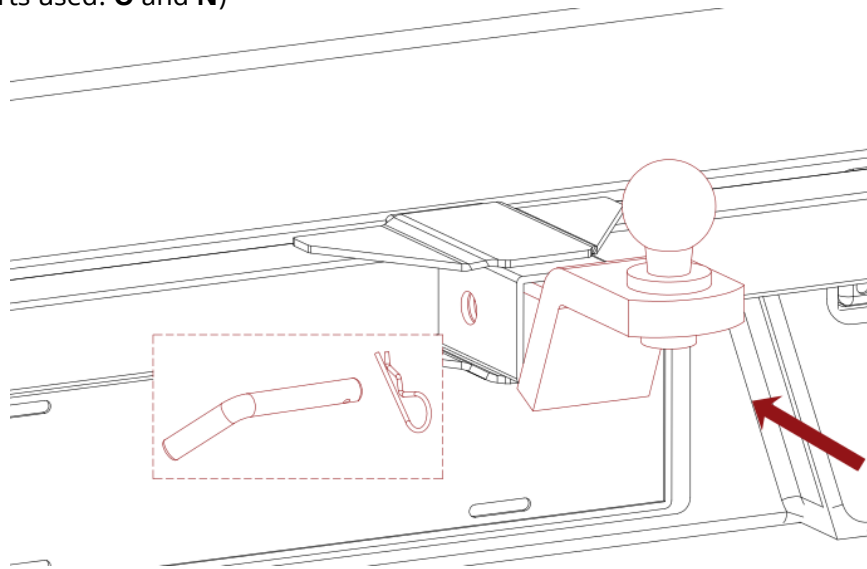

21. Mount the 13-Pin Wire Harness on the Adaptor Bracket Left Unit. Connect the multiplugs.
Note: We recommend using the Dust Cap (see step 16) when the wires are not connected
(Parts used: **S**)

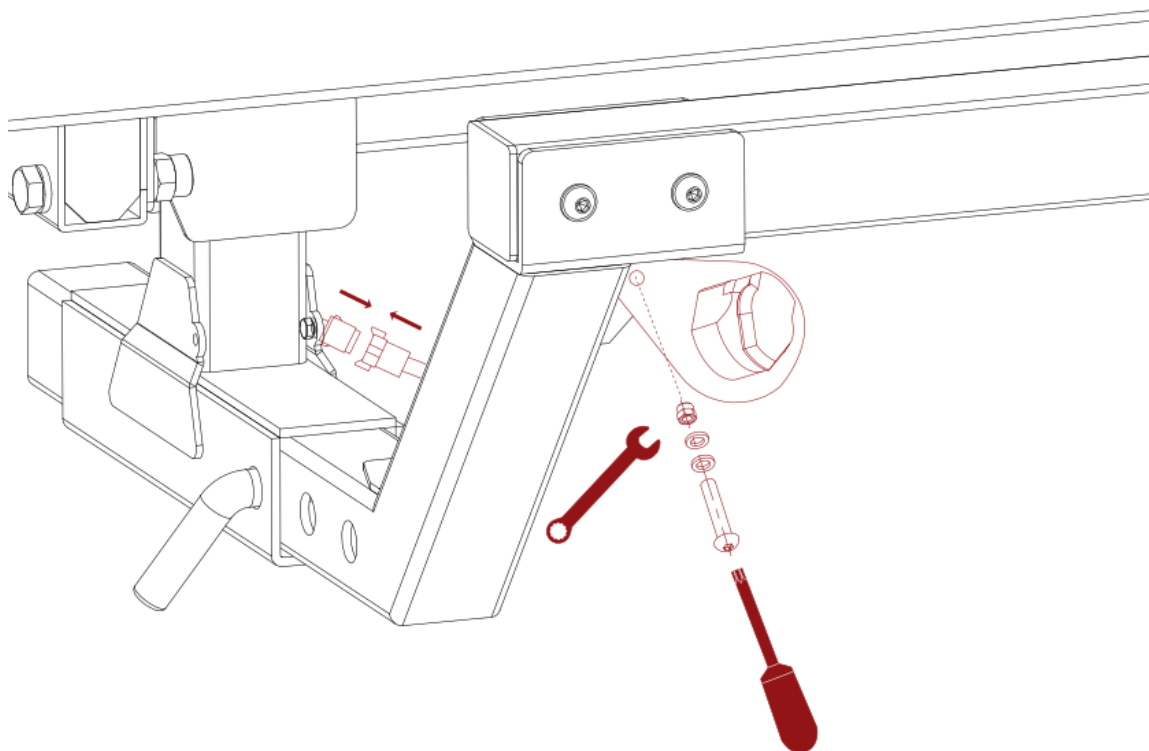

22. Remount the support brackets for the bumper like illustrated below.

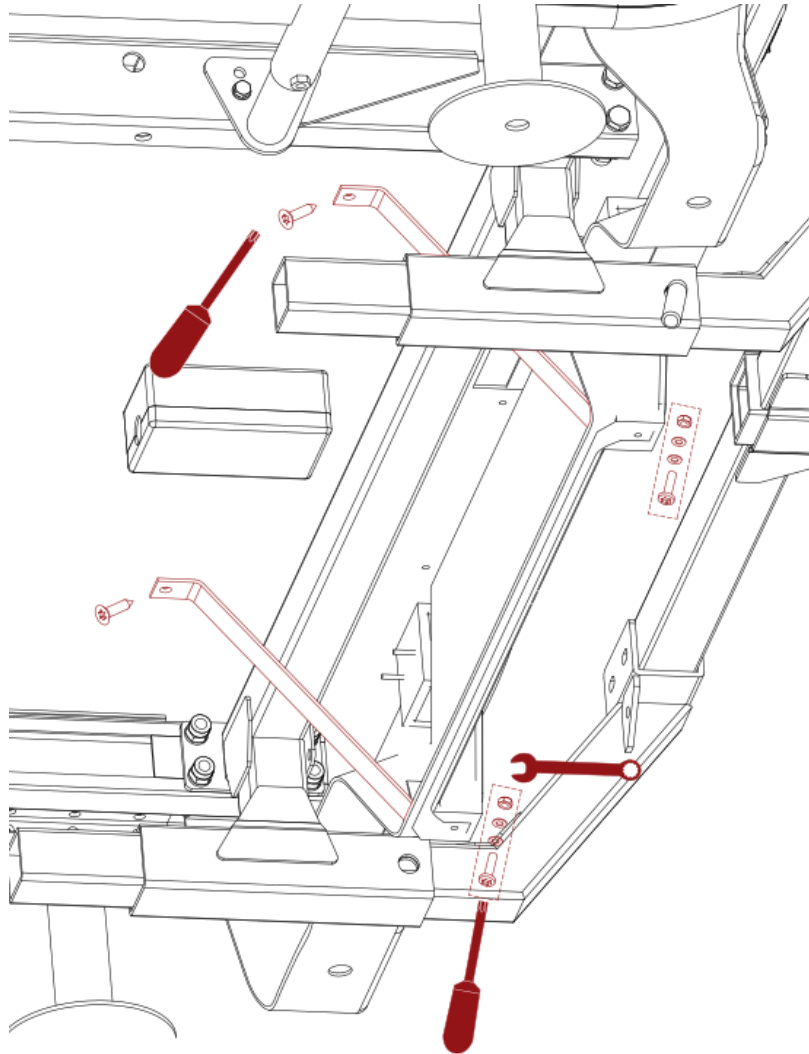

All products that are not mounted by an authorized HeroCamper dealer are at your own risk!